



Wyatts Green Road
Brentwood CM15 0GZ
£725,000

Wyatts Green Road, Brentwood, CM15 0GZ

This two bedroom detached bungalow is one of just 12 beautifully designed new build homes set in the peaceful hamlet of Swallows Cross.

To the left of the property, you'll find a contemporary kitchen/dining area finished to a high standard with integrated Siemens appliances, along with a separate utility room, family bathroom, and a generous living room, enhanced by bi-fold doors opening directly onto the rear garden,

There are two double bedrooms, both with direct access to the rear garden. The principal bedroom benefits from an en suite shower room.

Externally, the property includes two allocated parking spaces- one of which is equipped with an EV charging point. The south westerly facing rear garden enjoys uninterrupted views across open farmland and is mainly laid to lawn, complemented by a porcelain patio.

Full specification is available in the brochure.

Images shown may include computer-generated visuals, artist impressions, or photographs of show homes and are intended for illustrative purposes only. Actual finishes and layouts may vary. For plot-specific details, please contact the Sales Team at Walkers.



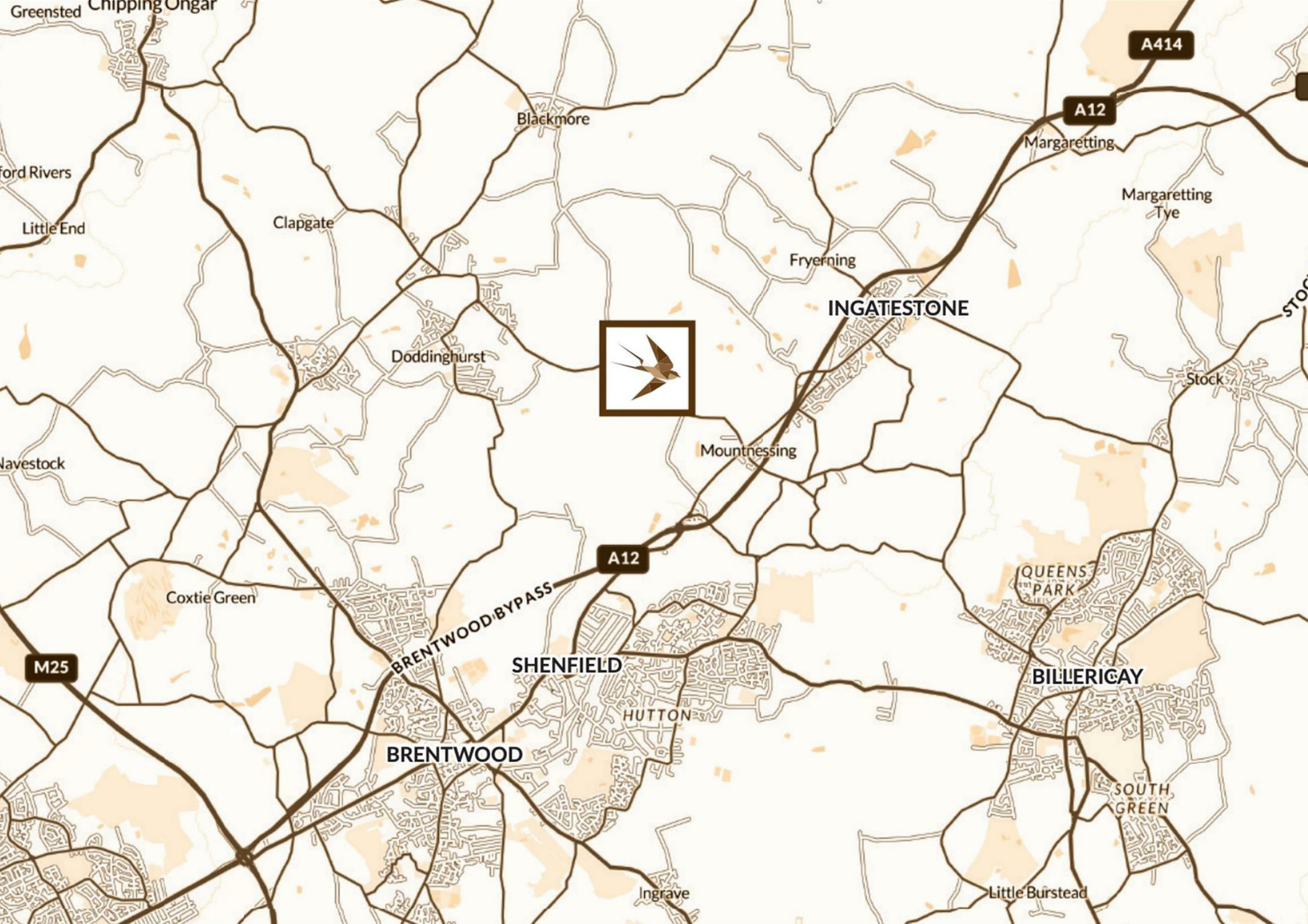



SWALLOW
FIELDS
BRENTWOOD

Ground Floor

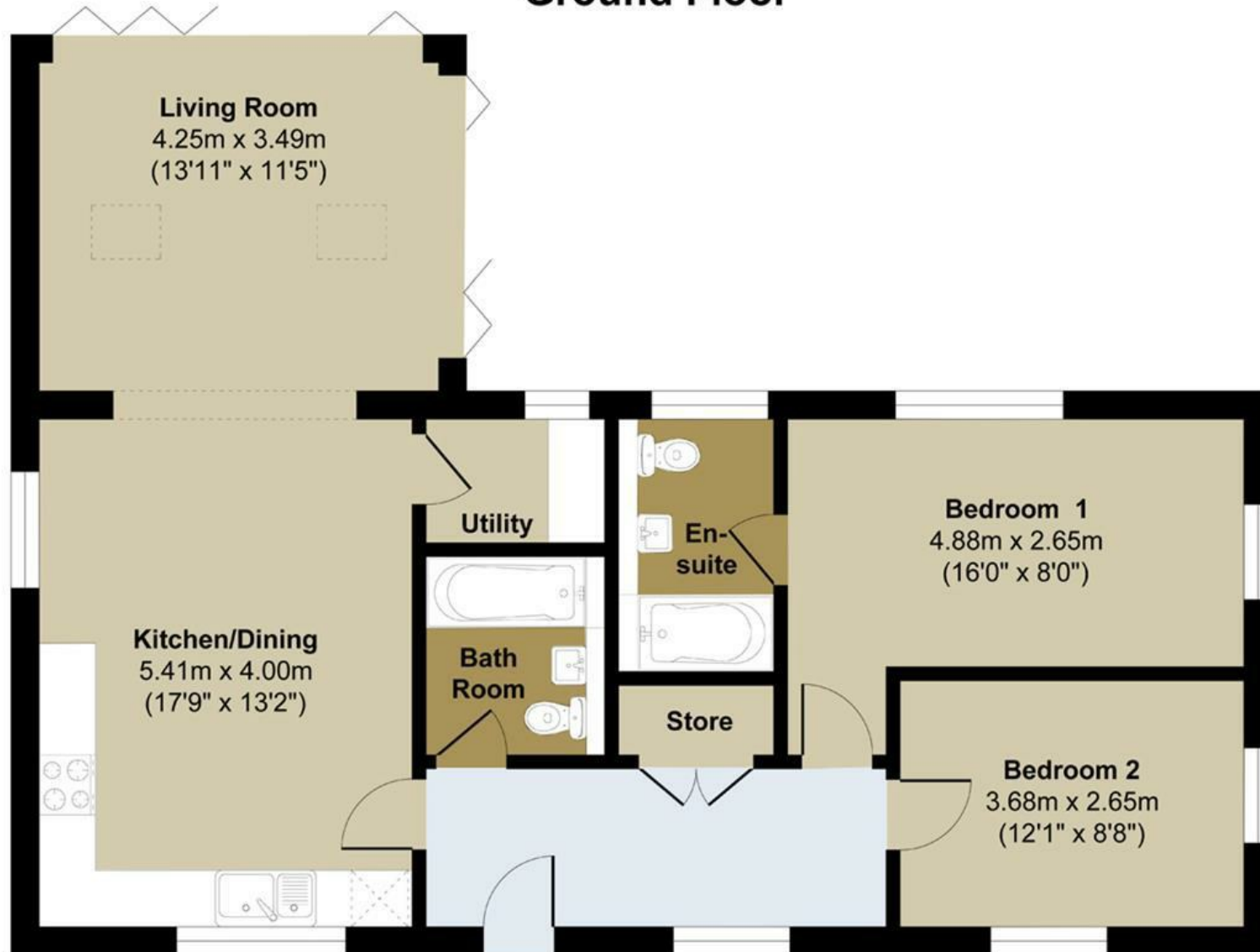



Energy Efficiency Rating		
	Current	Potential
Very energy efficient - lower running costs		
(92 plus) A		
(81-91) B		
(69-80) C		
(55-68) D		
(39-54) E		
(21-38) F		
(1-20) G		
Not energy efficient - higher running costs		
England & Wales	EU Directive 2002/91/EC	

Environmental Impact (CO ₂) Rating		
	Current	Potential
Very environmentally friendly - lower CO ₂ emissions		
(92 plus) A		
(81-91) B		
(69-80) C		
(55-68) D		
(39-54) E		
(21-38) F		
(1-20) G		
Not environmentally friendly - higher CO ₂ emissions		
England & Wales	EU Directive 2002/91/EC	

PLEASE CALL 01277 355005 TO ARRANGE A VIEWING

www.walkersestates.co.uk

INDEPENDENT ESTATE AGENTS - VALUATIONS WITH NO OBLIGATION – PROFESSIONAL SERVICE

These particulars do not constitute, nor constitute any part of an offer or contract. All measurements are given as a guide, no liability can be accepted for any errors arising therefrom. No responsibility is taken for any other error, omission, or mis-statement in these particulars. Walkers Village & Country Homes Limited do not make or give, whether in these particulars, during negotiations or otherwise, any representation whatsoever in relation to this property.

